



RTA I-UNIT ASSEMBLY INSTRUCTIONS

TOOLS REQUIRED



#2 Phillips Screwdriver



Rubber Mallet



Cordless Drill (Optional)

BASE KIT CONTENTS

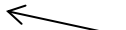

(1) Center Panel



(2) Wing Panels



(6) Confirmat Screws



(6) Screw Caps



(4) Camlock Pins



(4) Camlocks

ASSEMBLY

CAMLOCK INSTALLATION

NOTE: Assemble the base kit first, then position it to accept the I-Unit center panel.

1. Locate the green bag of hardware.
2. Screw (4) camlock pins into the pre-drilled holes on top of the base. (See Figure 1)
3. Install (4) camlocks into both of the wing panels using the rubber mallet. (See Figure 2)

Figure 1



Figure 2

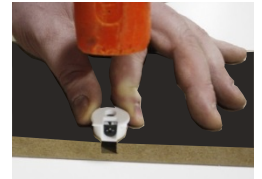

PANEL INSTALLATION

4. Attach both panel wings to the center panel using the confirmat screws. Be sure the camlocks are facing the center panel. (See Figures 3 and 4)

NOTE: Do not fully tighten screws until all the panels are in place. Once both wing panels are in place, tighten and snug the screws.

5. Set the center panel and wing assembly onto the base over the camlock pins and tighten into place.

Figure 3

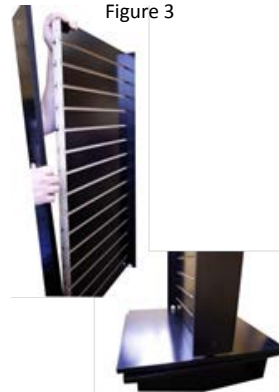

Figure 4



Figure 5

SCREW CAPS ADHESION

6. To cover the exposed screw heads, adhere the decorative screw caps.
7. Peel the decorative screw caps to expose the sticky back, and carefully center and cover the screw heads.



____ HARDWARE
 ____ CASTERS
 ____ INSTRUCTIONS
 ____ INITIALS
 ____ MONTH/DAY