

Anchor™ Core-24"H x 48"L Easy Panel 2-Pack

Anchor™ Core Easy Panels™ are easy to handle 24"H x 48"L panels with available accessories to help organize and display tools, supplies, sports equipment, and children's toys. Easy Panels™ can also organize home offices, art and craft areas, workrooms, laundry areas, closets, and any area requiring organization. Anchor™ Core Easy Panels™ can be modified to function in any area where you need to *make room for what you love*.

Anchor™ Core Easy Panels™ are made from Anchor™ Core. These engineered panels are 50% stronger than the standard Medium Density Fiberboard (MDF). Available in paintable, cherry, maple, and white. Two-pack is designed for ground shipment.

Accessories are available at www.garageescape.com

Additional information and installation instructions

For more information visit www.garageescape.com or www.windmillslatwall.com.

Call 800.548.7528 to speak to one of our expert Project Managers for more information.

Installation instructions are included with packaging.

GarageEscape™ is a division of Wind Mill Slatwall Products.

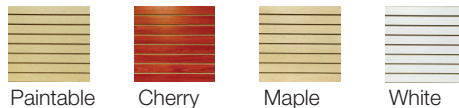

Ready-Sert™ Metal Inserts

Slatwall Easy Panels™ are grooved panels that can easily include the optional Ready-Sert™ metal inserts. Ready-Sert™ metal inserts will double the strength of the groove.



Half Grooves

Half grooves provide the option of stacking panels, providing a seamless connection and usable groove.

Anchor™ Core-24"H x 48"L Easy Panel 2-Pack

- Anchor™ Core is 50% stronger than MDF
- Seamless stacking
- Easy to install
- Two 24"H x 48"L sections per pack
- Available in paintable, cherry, maple, and white

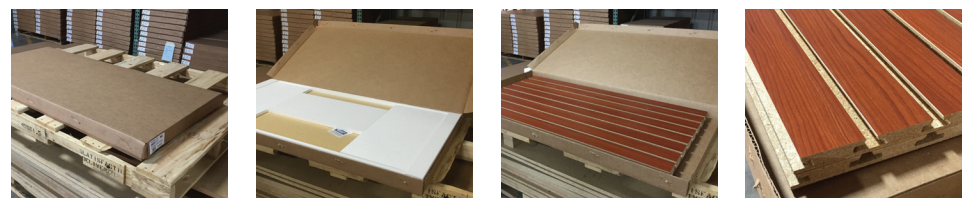

Anchor™ Core Easy Panels™ Installation Instructions

- Determine location where panels will be installed. Use a level to draw a straight line at desired height.
- When installing over drywall use a stud finder to mark the center of each stud on the pre drawn level line.
- Use correct length screws to attach panel to the wall, drilling through the grooves (see Illustration A below). Due to the uniqueness of each installation, **fastening screws are not included.**
- If cutting is required, cut wall panels with a power saw. The saw blade should enter the finished side of the wall panels (back side of board is facing up).

TIP: Mount panels approximately 48" from floor to bottom of panel.

TIP: For a single person installation, mount a level assist board to rest the panel on.

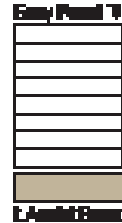

Watch installation video



Optional Ready-Sert™ Installation Instructions

- Remove one end cap from tube. Count the number of Ready-Serts™ to make sure all 15 pieces are included. NOTE: One (1) Ready-Sert™ is used when two panels are VERTICALLY stacked (see Illustration B below).
- Inserts should be installed in panel prior to any installation.
- Use #6 pan head sheet metal screws when mounting the optional Ready-Sert™.
- Drill two 1/8" pilot holes through the Ready-Sert™, at two stud locations at opposite ends of the panel. Using a power drill, drive the #6 pan head screw through the Ready-Sert™ and into the stud, being careful not to catch the lip of the insert with the screw.
- Complete the installation by drilling pilot holes and driving screws into each pre located stud and into every other groove. In a VERTICAL installation (see Illustration B below), make sure screws go through the Ready-Sert™ that is between the panels.

TIP: Screws larger than #6 will not fit in a Ready-Sert™.

Illustration A →
Install #6 pan head screws through the back of the grooves (**fastening screws are not included**)

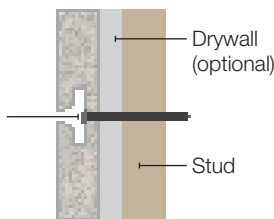
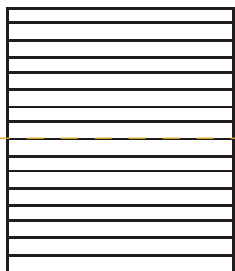
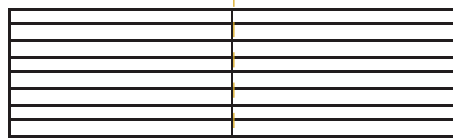

Illustration B ↴
Vertical Installation



Horizontal Installation



GarageEscape™ is a division of Wind Mill Slatwall Products.

Accessories

Accessories provide the ability to create personalized organization providing a simple way to arrange and rearrange products. Use shelves, baskets, and various hooks to meet your organizational needs. Visit www.GarageEscape for details.

Necessary Tools

- Safety goggles
- Tape measure
- Stud finder
- Level
- #6 pan head sheet metal screws
- Drill (screw gun)

Safety First

Use all tools according to the manufacturer's recommendations.

Dos and Do Not

- DO distribute weight equally on the panels.
- DO use tools per manufacturer's recommendations.
- DO NOT climb, hang, or step on accessories.
- DO NOT overload accessories with additional weight.
- DO NOT drop heavy items on accessories.